

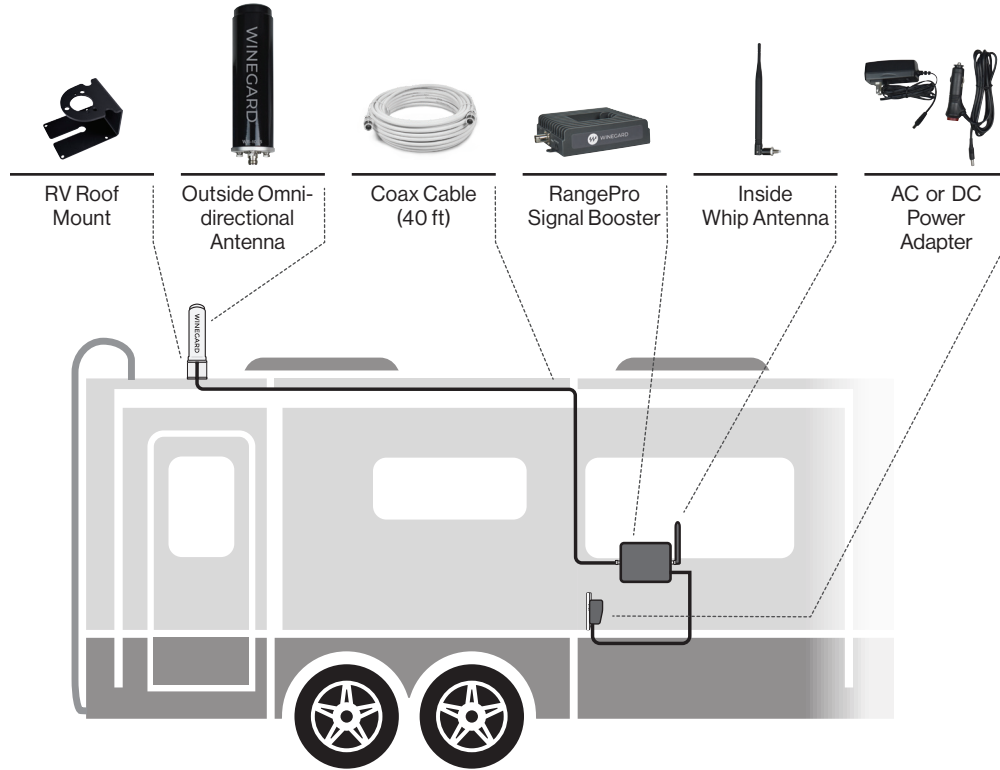

WINEGARD® RangePro™

Cell Booster for RVs

WB-1035 QUICK SETUP GUIDE



The Winegard RangePro is designed to work with existing cellular signals, and cannot be used as a standalone cellular hotspot. A cellular plan and device are required for operation.

STEP 1 INSTALL THE SIGNAL BOOSTER AND CONNECT INSIDE ANTENNA

Identify a location for the booster that is near the center of where signal is needed. The location should be free from excessive heat, direct sunlight, or moisture—and provide proper ventilation. (We suggest you mount the booster within a cabinet or on a side panel close to a power source.)

Connect the inside whip antenna to the port on the side of the booster labeled "INSIDE".

Note: The inside antenna sends signals in a 360-degree radius and should be positioned vertically.

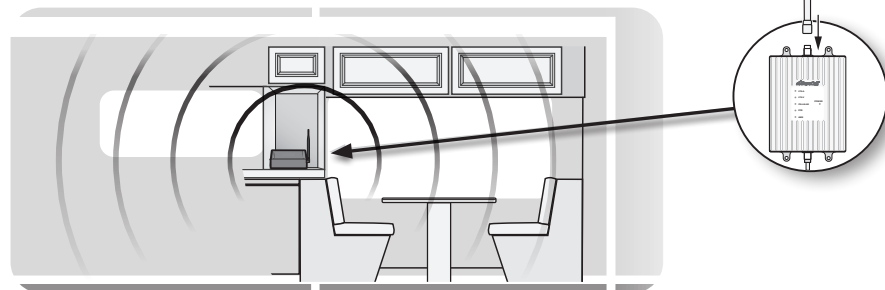

STEP 2 SELECT A SITE FOR THE OUTSIDE MOUNT

Note: To avoid possible interference, mount the antenna at least 15' away from the indoor booster and allow at least 3' from other RF products (such as satellites and over-the-air antennas).

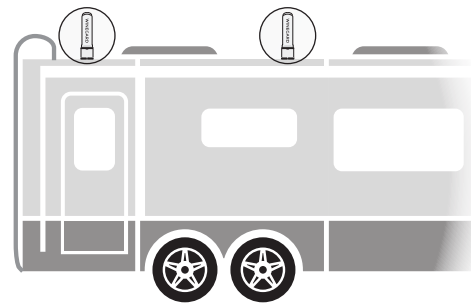

The outside antenna must not be collocated or operating with any other antenna or booster. Maximum height restriction is 31' 9" (10 meters) above ground.

We advise you first perform a "soft" installation by routing the outside antenna cable through an open window (step 4). After completing the "soft" installation and verifying successful operation, proceed with installing the external antenna.

Select a location for the outside antenna that is above the roofline. The outside antenna is omni-directional, which receives and sends signals in a 360-degree radius. For maximum performance, mount the antenna at the highest possible location outside the vehicle and in an upright position, but also ensure this is a spot where you can drill a hole for cable entry.

STEP 3 MOUNT OUTSIDE ANTENNA ON ROOF

1. After selecting the outside antenna position, drill the cable hole through the roof in an area free from other cables or pipes.
2. Feed the small end of the cable through the hole until only the connector and 1" of coax remain outside the coach.
3. Remove the three screws and washers that are attached to the outside antenna.
4. Place the antenna through the hole on the top of the roof mount.
5. Align the two small holes located on the bottom side of the antenna with the two small holes on top of the roof mount. Next, reattach the three screws and washers through the roof mount and into the holes on the base of the antenna.

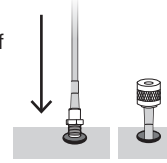

6. Position the roof mount over the cable, threading the cable through the mount's channel.
7. Secure the mount on the roof by inserting and tightening the provided screws into the four mounting holes. *Verify the provided screws are approved with the vehicle manufacturer before installing.*

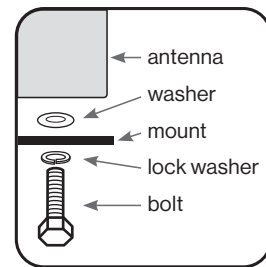
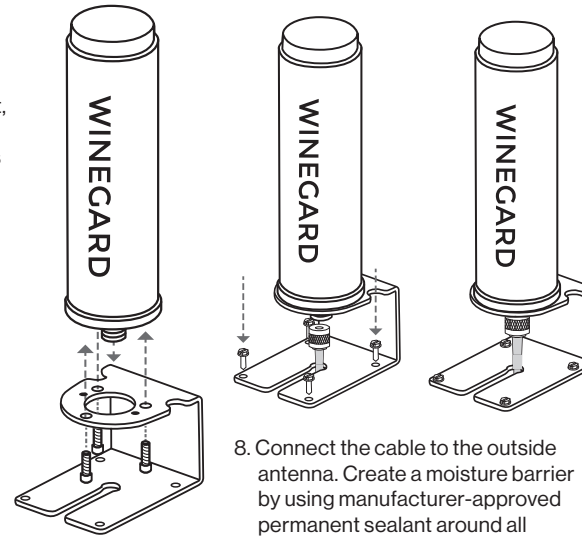

8. Connect the cable to the outside antenna. Create a moisture barrier by using manufacturer-approved permanent sealant around all screws and holes in the RV roof.

OR MOUNT OUTSIDE ANTENNA USING OPTIONAL LADDER MOUNT

Before you begin, please note that this installation requires the use of a ladder, mast or RV mounting system on which to mount the outside antenna.

1. Remove the three screws and washers that are attached to the outside antenna.
2. Place the antenna through the hole on the top of the roof mount and reattach 3 screws and washers.
3. Assemble the L-bracket with U-bolts, brackets, nuts and washers and secure to mast as shown in the illustration.
4. Secure antenna to the horizontal plate of L-bracket using screws.

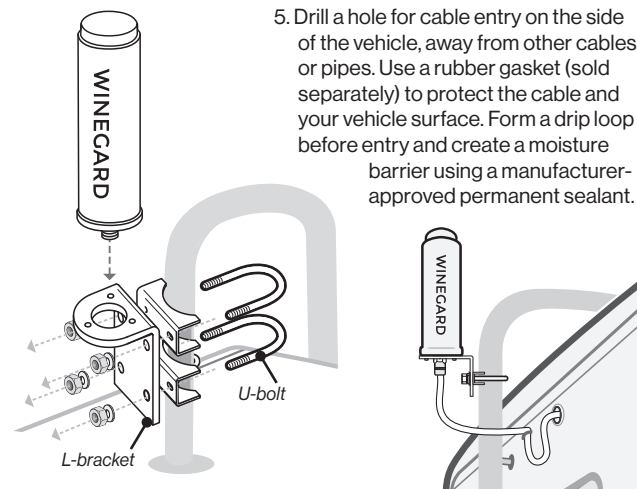

STEP 4 CONNECT POWER AND VERIFY SUCCESSFUL OPERATION

1. Inside the vehicle, connect the cable leading to the outside antenna to the port on the booster labeled "OUTSIDE." Make sure that all connections are secure before powering on.
2. Finish permanent cable installation by securing any loose cables inside the vehicle.
3. Connect the AC power adapter (or 12V adapter) to the signal booster and plug it into power.

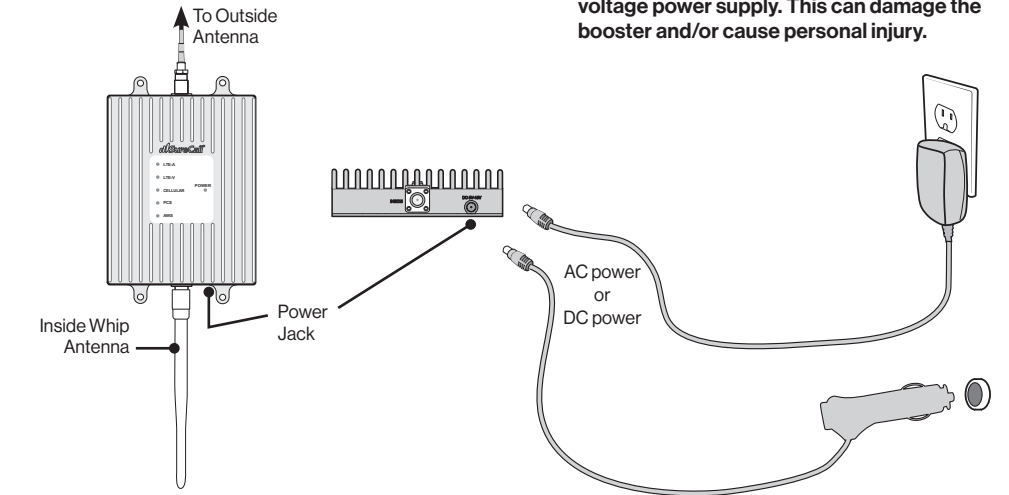

The Power LED will light, indicating that the signal booster is ready for use. Place a call in a location you have previously experienced poor signal and confirm that your phone is receiving a boosted signal. Normal operation is indicated by green LEDs (both flashing and solid). In the event red LEDs appear, antenna adjustments may be needed.

WARNING: The booster is rated for 6-15V input voltage. DO NOT use the booster with a higher voltage power supply. This can damage the booster and/or cause personal injury.

TROUBLESHOOTING

| Problem | Resolution |
|---|---|
| Signal booster has no power | Verify that the Power LED is ON. Connect the power supply to an alternate power source. Verify that the power source is operational and the fuse is intact. If it remains OFF, contact tech support at: 1-855-433-2291 |
| After completing installation, signal coverage has not improved | Verify that cable connections are tightly fitted to the booster. Try further separating the antennas. NOTE: Bars are not always a reliable measure of signal. The best way to confirm signal coverage is the ability to place and hold a call. |
| The booster case is warm | The booster case may become warm during operation. This is normal. |

LED INDICATORS

| Color | Condition | Indication |
|-------|-----------|---|
| Green | Solid | Indicates normal operation. |
| Green | Flashing | Normal operation. Indicates that Automatic Gain Control (AGC) is self-adjusting due to over-signal or antenna proximity. |
| Red | Flashing | Indicates issues caused by overpowering or oscillation. Adjust your outside and inside antenna locations to maximize separation between them by increasing distance as well as adding obstructions. |

Have questions?

We have answers! Reach out to our US-based support team:

Call: 855-433-2291

Visit: www.winegard.com/support

To register your product please visit winegard.com/login and create an account. You can then register your product(s) by clicking the Manage My Accounts button.

Manuel disponible en français au www.winegard.com/support



3-YEAR WARRANTY

Winegard warrants its products for three years from the date of purchase against defects in workmanship and/or materials. Specifications are subject to change. The three-year warranty only applies to products meeting the latest FCC Certification Guidelines stated on 2/20/2013 and going into effect April 30, 2014. Products returned by customers must be in their original, un-modified condition, shipped in the original or protective packaging with proof-of-purchase documentation enclosed, and a Return Merchandise Authorization (RMA) number printed clearly on the outside of the shipping container. Buyers may obtain an RMA number for warranty returns by calling the Return Department toll-free at 855-433-2291. Any returns received without an RMA number clearly printed on the outside of the shipping container will be returned to sender. In order to receive full credit for signal boosters, all accessories originally included in the signal booster box must be returned with the signal booster. The Buyer does not need to include accessories sold in addition to the signal booster. This warranty does not apply to any product determined by Winegard to have been subjected to misuse, abuse, neglect, or mishandling that alters or damages the product's physical or electronic properties. Winegard warrants to the Buyer that each of its products, when shipped, will be free from defects in material and workmanship, and will perform in full accordance with applicable specifications. The limit of liability under this warranty is, at Winegard's option, to repair or replace any product or part thereof as determined by examination by Winegard and proven defective in material and/or workmanship. Warranty returns must first be authorized in writing. Disassembly of any Winegard product by anyone other than an authorized representative voids this warranty in its entirety. Winegard reserves the right to make changes in any of its products without incurring any obligation to make the same changes on previously delivered products. Products sold by Winegard shall not be considered defective or non-conforming to the Buyer's order if they satisfactorily fulfill the performance requirements that were published in the product specification literature, or in accordance with samples provided by Winegard. This warranty shall not apply to any products or parts thereof which have been subject to accident, negligence, alteration, abuse, or misuse. Winegard makes no warranty whatsoever in respect to accessories or parts not supplied by it.

LIMITATIONS OF WARRANTY, DAMAGES AND LIABILITY

Except as expressly set forth herein, there are no warranties, conditions, guarantees, or representations as to merchantability, fitness for a particular purpose, or other warranties, conditions, guarantees, or representations, whether expressed or implied, in law or in fact, oral or in writing. Winegard aggregate liability in damages or otherwise shall not exceed the payment, if any, received for the unit of product or service furnished or to be furnished, as the case may be, which is the subject of a claim or dispute. In no event shall Winegard be liable for incidental, consequential, or special damages, howsoever caused. All matters regarding this warranty shall be interpreted in accordance with the laws of the State of Minnesota, and any controversy that cannot be settled directly shall be settled by arbitration in Minnesota in accordance with the rules then prevailing of the American Arbitration Association, and judgment upon the award rendered may be entered in any court having jurisdiction thereof. If one or more provisions provided herein are held to be invalid or unenforceable under applicable law, then such provision shall be ineffective and excluded to the extent of such invalidity or unenforceability without affecting in any way the remaining provisions hereof.

SAFETY INFORMATION

This is a CONSUMER device. BEFORE USE, you MUST REGISTER THIS DEVICE with your wireless provider and have your provider's consent. Most wireless providers consent to the use of signal boosters. Some providers may not consent to the use of this device on their network. If you are unsure, contact your provider. You MUST operate this device with approved antennas and cables as specified by the manufacturer. Antennas MUST be installed at least 20 cm (8 inches) from any person. You MUST cease operating this device immediately if requested by the FCC or a licensed wireless service provider.

WARNING: E911 location information may not be provided or may be inaccurate for calls served BY USING THIS DEVICE. Winegard has made a good faith effort to ensure the accuracy of the information in this document and disclaims the implied warranties of merchantability and fitness for a particular purpose and makes no express warranties, except as may be stated in its written agreement with and for its customers. Winegard shall not be held liable to anyone for any indirect, special or consequential damages due to omissions or errors. The information and specifications in this document are subject to change without notice.

Specifications

| | |
|---------------------------|---|
| Product: | RangePro WB-1035 |
| Uplink Frequency Range: | 698-716 / 776-787 / 824-849 / 1850-1915 / 1710-1755 (MHz) |
| Downlink Frequency Range: | 728-746 / 746-757 / 869-894 / 1930-1995 / 2110-2155 (MHz) |
| Supported Standards: | CDMA, WCDMA, GSM, EDGE, HSPA+, EVDO, LTE and all cellular standards |
| Input / Output Impedance: | 50 Ω |
| Maximum Gain: | 50 dB |
| Noise Figure: | ≤ 5 dB |
| VWSR: | ≤ 2.0 |
| Gain Adjustment: | 20 dB (Automatic) |
| DC Power: | 6-15V |
| Maximum Output Power: | 1 Watt EIRP |
| Cable: | SC-240 |
| RF Connectors: | FME Male (both ends) |
| Power Consumption: | ≤ 10W |
| Operation Temperature: | -4° to +158° F |
| Dimensions: | 5.625 x 4 x 1.125 inches |
| Weight: | 1.43 lbs |
| Certifications: | FCC ID: RSNF2GO3 / IC: 7784A-F2GO3 |

WARNING: Unauthorized antennas, cables, and/or coupling devices are prohibited by FCC new rules. Changes or modifications not expressly approved by Winegard could void the user's authority to operate the equipment.

FCC 27.50(d)(4) Statement: Fixed, mobile and portable (hand-held) stations operating in the 1720-1755 MHz band are limited 1 Watt EIRP. Fixed stations operating in this band are limited to a maximum antenna height of 10 meters above ground. Mobile and portable stations operating in this band must employ a means for limiting power to the minimum necessary for successful communications.

FCC 15.105 Statement This equipment has been tested and found to comply with the limits for a Class B digital device, pursuant to part 15 of the FCC Rules. These limits are designed to provide reasonable protection against harmful interference in a residential installation. This equipment generates, uses and can radiate radio frequency energy and, if not installed and used in accordance with the instructions, may cause harmful interference to radio communications. However, there is no guarantee that interference will not occur in a particular installation. If this equipment does cause harmful interference to radio or television reception, which can be determined by turning the equipment off and on, the user is encouraged to try to correct the interference by one or more of the following measures:

- Reorient or relocate the receiving antenna.
- Increase the separation between the equipment and receiver.
- Connect the equipment into an outlet on a circuit different from that to which the receiver is connected.
- Consult the dealer or an experienced radio/TV technician for help.

15.19 This device complies with Part 15 of the FCC Rules. Operation is subject to the following two conditions: (1) this device may not cause harmful interference, and (2) this device must accept any interference received, including interference that may cause undesired operation.

WINEGARD® RangePro™

Cell Booster for RVs

Powered by



WINEGARD®

WINEGARD COMPANY 2736 MT.PLEASANT ST. | BURLINGTON, IA 52601

©2020 Winegard Company 2452456 Rev2-22