



Roof Mount Kit RK-4000

For a complete list of compatible antennas, visit
www.winegard.com/mounts

For help, email help@winegard.com
or call 1-800-788-4417



Mounting foot (4)
with Screw (4)



Cable entry plate



Mounting
screw (20)



Cable tie (2)

Installing the Mounting Feet

1. If the handle has been installed on the antenna, remove the screws holding the handle to the antenna with a Phillips screwdriver, and remove the handle.
2. Pull off the rubber foot pads from the bottom of the four antenna feet.



3. Insert the threaded post up through the hole of each attached foot, and with a Phillips screwdriver, tighten a screw into each.

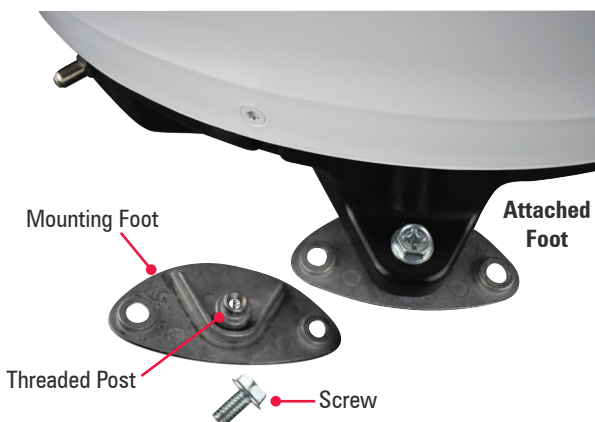

Installing the Antenna

1. Do not attempt to install the antenna in the rain or under any wet conditions. Install in dry conditions only.
2. For best performance and to reduce signal acquisition time, park the vehicle on a level surface that is free of obstructions such as trees or large buildings. Make sure you have a clear view of the southern sky.
3. Select a level spot on your roof for installation. Level the base front-to-back and side-to-side. If the base is not level, the antenna may require more time to locate the correct satellite or may not locate the correct satellite.
4. Ensure proper distance to other rooftop equipment is maintained. Be sure no roof-mounted equipment is blocking the satellite "line of sight"; see clearance requirements below.

Signal Obstruction Chart

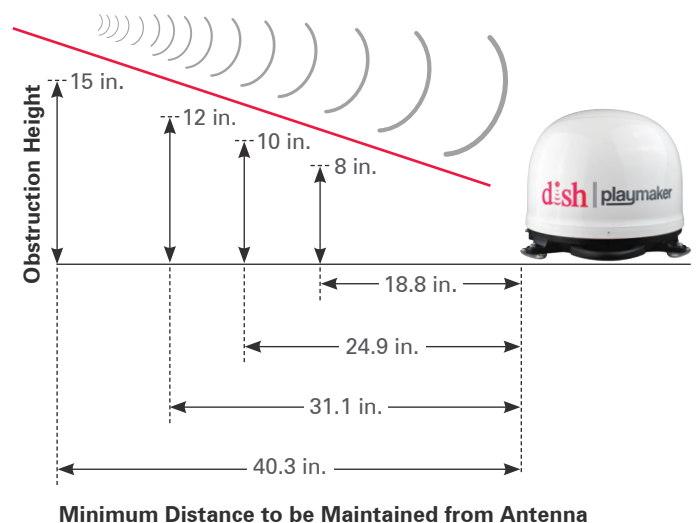



Roof Mount Kit RK-4000

Installing the Antenna (cont)

5. After selecting a location for the antenna, make sure that the centerline of the antenna is on or parallel to the centerline of the vehicle; the centerline of the antenna runs through the point between the two feet where cable connections are located.
6. Position the antenna with cables exiting toward the rear of the vehicle.

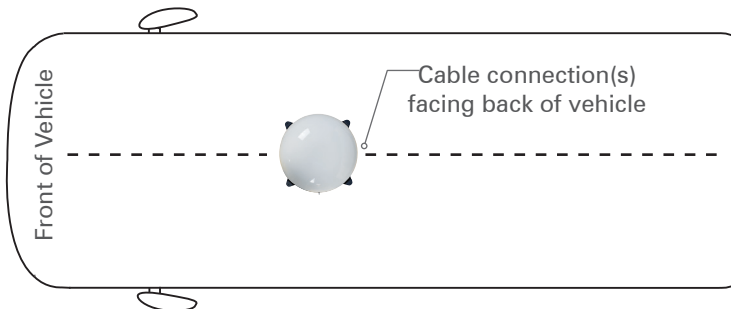

7. To ensure proper installation, check that the distance from the edge of the roof to any foot is at least twelve inches.
8. Place the unit on the roof in its permanent location, and mark around each base foot.
9. Clean the roof area where the base feet will attach to the roof; do not erase your marks.
10. Check with your vehicle manufacturer for approved sealant, and put approved sealant in the areas marked for the base feet. Place the base feet on top of the sealant.

WARNING It is not recommended to mount the antenna directly to a vehicle without using the roof kit accessory. Failure to follow proper installation instructions could cause damage and/or potential injury.

The DISH Playmaker / DISH Playmaker Dual are **NOT** intended to be mounted onto over-the-road trucks or for marine applications.

11. Before using the supplied mounting screws, check with your vehicle manufacturer for any special screw requirements. Screw down with two screws for each foot. After all base feet are secured to the roof, put sealant around the edge of feet and over screws.
12. Decide the best location for coax cable(s) to enter the vehicle. Consider the location of the receiver(s).
13. Drill a hole in the roof for the coax cable(s), and push the cable(s) inside, making sure the coax cable(s) are accessible from the area where the receiver(s) will be located.
14. For the Playmaker, connect a coax cable from the "Satellite In" port of the receiver to the port on the antenna.
For the Playmaker Dual, connect a coax cable from the "Satellite In" port of the primary receiver to the main port on the antenna. If connecting the antenna to two receivers, connect a second coax cable (not provided) to the secondary port on the antenna.
15. Place the provided cable entry plate over the hole and cables. Screw the plate in place with eight mounting screws. Seal the plate and screw holes with approved sealant (not included).
16. Secure excess cable with the provided cable ties. Securing every 12–16" should eliminate any unnecessary cable movement.

NOTE You will use 16 screws for installation.
The kit includes 20.

Disclaimer: Although every effort has been made to ensure that the information in this manual is correct and complete, no company shall be held liable for any errors or omissions in this manual. Information provided in this manual was accurate at time of printing. DISH and Playmaker are registered trademarks of DISH Network L.L.C. Winegard is a registered trademark of Winegard Company.