



SATELLITE TV ANTENNA LADDER MOUNT

MT-4000

INSTALLATION MANUAL

For poles with outer diameters between 1" to 1-1/8"



Designed
for RV use



For a complete list of all compatible antennas, visit
www.winegard.com/mounts



WARNING: DO NOT USE THE LADDER MOUNT AS A STEP!

Manual disponible en español
en www.winegard/support

Manuel disponible en français
au www.winegard/support

MT-4000 CONTENTS

- A • Extension Tube (1)
- B • Ladder Bracket (2)
- C • Mounting Plate (1)
- D • Hardware Bag (1)

B (Left & Right Bracket)

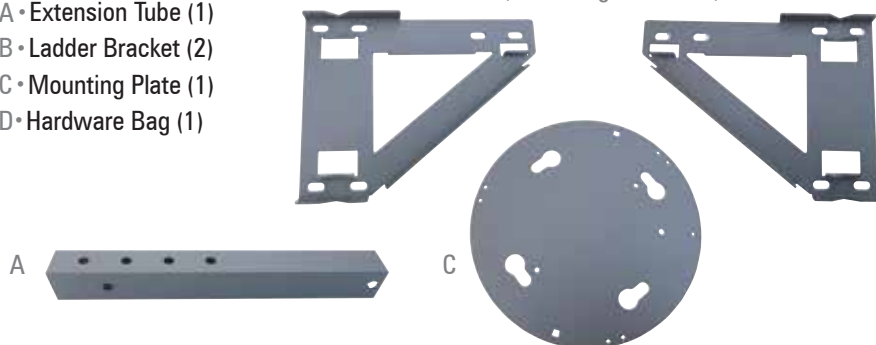

D • Hardware Bag Contents:

- | | |
|-----------------------|----------------------------------------|
| E • Locking Bolt (1) | I • Lock Washer (1) |
| F • Carriage Bolt (8) | J • Dome Screw w/blue coating (6) |
| G • Nylock Nut (8) | K • Rubber Foot Screw w/blue patch (4) |
| H • Flat Washer (8) | |



MT-4000 Ladder Mount Assembly:

Determine how far from the ladder or mounting pole you will need the antenna. Use Figure 1 to determine which of the mounting holes will best meet your application.

- 1) Line up the two holes in the left mounting bracket shown in Figure 1 with the two holes on the extension tube that will work best for your application.
- 2) From the flat or outside of the left mounting bracket, insert a carriage bolt into each of the two holes you lined up in Step 1. Refer to Figure 2.
- 3) Place the right mounting bracket on the extension tube so that the bolts you inserted in Step 2 extend through the holes in the right mounting bracket. Place a flat washer and thread one of the nylock nuts onto each of these bolts.

DO NOT TIGHTEN AT THIS TIME!

- 4) Install the mounting plate by lining up the two holes shown in Figure 3 with the two holes on the top of the extension tube.

NOTE: The mounting plate may be installed with either surface facing up.

With the holes lined up, insert a carriage bolt into each of the holes so that the head of the bolt is on top of the mounting plate.

- 5) Place a flat washer and thread one of the nylock nut onto each of the two bolts holding the mounting plate to the extension tube. Tighten these nuts, making sure they are snug, see Figure 4.

FIGURE 1



FIGURE 2

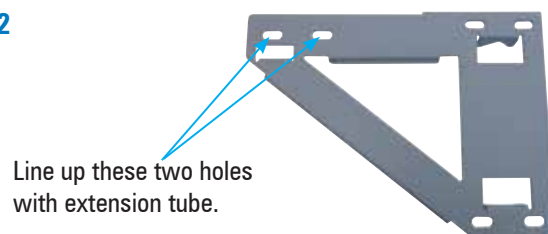

FIGURE 3

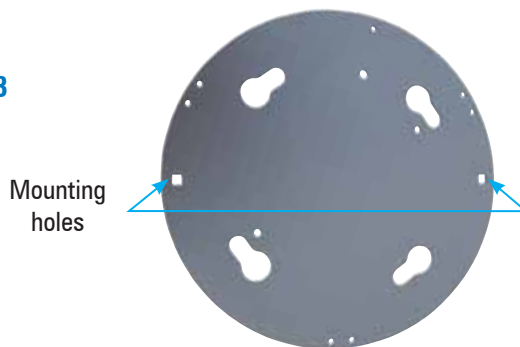
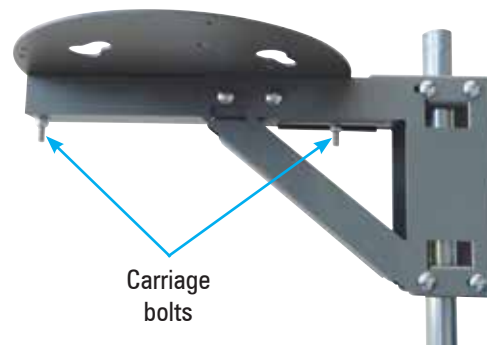

FIGURE 4



Installing the Ladder Mount:



WARNING: The MT-4000 Ladder Mount with antenna installed weighs 20 lbs. Verify that your mounting pole can support this weight while you travel.

- 1) Spread the left and right mounting brackets apart to allow the ladder mount to slide onto the rail of the ladder or mounting pole.
- 2) Insert two carriage bolts into the top two holes shown in Figure 5. Place a flat washer and thread a nylock nut onto each bolt. Move the ladder mount to the desired height. When the ladder mount is in place, tighten the two nuts until they are snug.
- 3) Tighten the nuts holding the brackets and extension tube together. Make sure these nuts are snug.
- 4) Insert the last two carriage bolts into the bottom two holes. Place a flat washer and thread a nylock nut onto each of these bolts and tighten the nuts until they are snug.

Attaching the Antenna on the Ladder Mount:



WARNING: Failure to follow these instructions may lead to property damage, personal injury, and/or death.

- 1) Disconnect the power and coax cables from the base of the antenna.
- 2) Remove the dome screws with a Phillips screwdriver, and lift off the dome. Locate and remove the security loop nuts, remove the security loop and reattach the dome using the new dome screws included with the ladder mount.
- 3) Remove rubber feet from dome and reinstall using new rubber foot screws included in the ladder mount.
- 4) Set the antenna on the mounting plate, lining up the feet of the antenna so that they fit into the holes in the mounting plate.

NOTE: Locate the hole in the base of the antenna and line it up with the hole in the mounting plate for the locking bolt before attaching the antenna, see Figure 6.

- 5) Twist the antenna to rotate the feet into the slots that hold the antenna in place while travelling.
- 6) Slide the lock washer onto the threads of the locking bolt.

- 7) Thread the locking bolt into the hole in the bottom of the mounting plate and into the matching hole in the base of the antenna to keep the unit from rotating back out of the slots holding the antenna in place.
- 8) Connect the ladder mount's coax and power cables to the antenna.

To remove the antenna, simply reverse these steps.

FIGURE 5

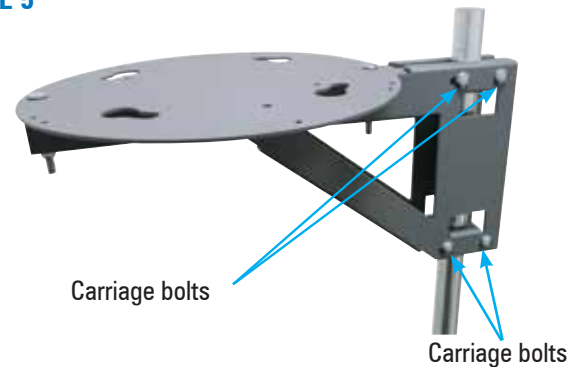
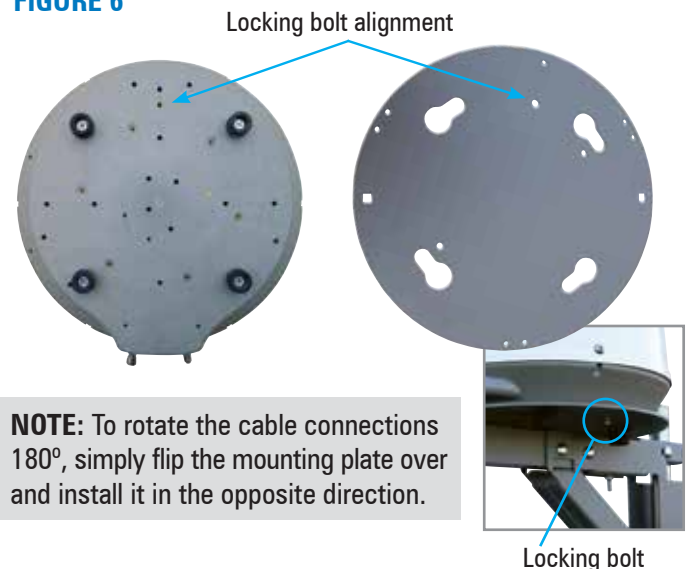

FIGURE 6



NOTE: To rotate the cable connections 180°, simply flip the mounting plate over and install it in the opposite direction.



WARNINGS:

- The MT-4000 Ladder Mount with the antenna installed weighs 20 lbs. Verify that your mounting pole can support this weight while you travel.
- The antenna needs a clear view of the southern sky. The vehicle will either need to park with the ladder mount facing south or the ladder mount will need to be installed high enough to allow the antenna to see over the vehicle.
- The antenna is for stationary use only and will not function while the vehicle is in motion.
- All nylock nuts for the ladder mount **MUST** be tight to prevent them from vibrating loose while the vehicle is in motion.
- The locking bolt **MUST** be in place and tight while the antenna is installed on the ladder mount.

WINEGARD MOBILE PRODUCTS LIMITED WARRANTY (2 YEARS PARTS; 1 YEAR LABOR)

Winegard Company warrants this product against defects in materials or workmanship for a period of two (2) years from the date of original purchase. During year one (1) of such warranty, Winegard Company will also pay authorized labor costs to an authorized Winegard dealer to repair or replace defective products. No warranty claim will be honored unless at the time the claim is made, Customer presents proof of purchase to an authorized Winegard dealer (to locate the nearest authorized Winegard dealer, contact Winegard Company, 3000 Kirkwood Street, Burlington, Iowa 52601, Telephone 800-288-8094 or visit www.winegard.com). Customer must provide proof of purchase with a dated sales receipt for the Winegard product to verify the product is under warranty. If the date of purchase cannot be verified, the warranty period shall be considered to begin thirty (30) days after the date of manufacture.

If a defect in material or workmanship is discovered, Customer may take the product to an authorized Winegard dealer for service. Customer must provide proof of purchase to verify the product is under warranty. If the product is brought to an authorized Winegard dealer for service prior to expiration of year one (1) of the warranty period and a defect in material or workmanship is verified by Winegard Technical Services, Winegard Company will cover the Winegard dealer's labor charges for warranty service. The Winegard dealer must contact Winegard Technical Services in advance for pre-approval of the service. Approval of the service is at the sole discretion of Winegard Company.

Alternatively, Customer may ship the product prepaid to Winegard Technical Services (located at 2736 Mt. Pleasant Street, Burlington, Iowa 52601, Telephone 800-788-4417). Customer must return the product along with a brief description of the problem and provide Winegard Technical Services with Customer's name, address, and phone number. Customer must also provide proof of purchase to verify the product is under warranty. If the product is returned before the expiration of the warranty period, Winegard Company will (at its option) either repair or replace the product.

This Limited Warranty does not apply if the product has been damaged, deteriorates, malfunctions or fails from: improper installation, misuse, abuse, neglect, accident, tampering, modification of the product as originally manufactured by Winegard in any manner whatsoever, removing or defacing any serial number, usage not in accordance with product instructions or acts of nature such as damage caused by wind, lightning, ice or corrosive environments such as salt spray and acid rain. This Limited Warranty also does not apply if the product becomes unable to perform its intended function in any way as a result of the television signal provider making any changes in technology or service.

RETURN AUTHORIZATION POLICY

A Return Material Authorization (RMA) is required prior to returning any product to Winegard Company or Winegard Warranty Services under this warranty policy. Please call our Technical Services Department at 800-788-4417 or send an email to warranty@winegard.com to obtain the RMA number. Please furnish the date of purchase when requesting an RMA number. Enclose the product in a prepaid package and write the RMA number in large, clear letters on the outside of the package. To avoid confusion or misunderstanding, a shipment(s) without an RMA number(s) or an unauthorized return(s) will be refused and returned to Customer freight collect.

WINEGARD COMPANY DOES NOT ASSUME ANY LIABILITIES FOR ANY OTHER WARRANTIES, EXPRESS OR IMPLIED, MADE BY ANY OTHER PERSON.

ALL OTHER WARRANTIES WHETHER EXPRESS, IMPLIED OR STATUTORY INCLUDING WARRANTIES OF FITNESS FOR A PARTICULAR PURPOSE AND MERCHANTABILITY ARE LIMITED TO THE TWO YEAR PERIOD OF THIS WARRANTY.

In states that do not allow limitations on implied warranties, or the exclusion of limitation of incidental or consequential damages, the above limitations or exclusions do not apply.

Some states do not allow limitations on how long an implied warranty lasts, or the exclusion of limitation of incidental or consequential damages, so the above limitations or exclusions may not apply to you.

This warranty gives Customer specific legal rights. Customer may also have other rights that may vary from state to state.

SATELLITE RECEIVER WARRANTY

See manufacturer's limited warranty policy.

WS-MOBWARREV3

Disclaimer: Although every effort has been made to ensure that the information in this manual is correct and complete, no company shall be held liable for any errors or omissions in this manual. Information provided in this manual was accurate at time of printing. If the antenna mount does not function as expected, please contact Winegard Company at help@winegard.com or 1-800-788-4417, or visit our website at www.winegard.com.